



Product Overview

The Blaze BT 1410 is a durable flanged swing check valve with a metal-to-metal seat, designed to prevent reverse flow in fluid systems. It offers reliable backflow protection and long service life, making it ideal for water, oil, and gas pipelines.

Material List

| No. | Part Name | Material | Specification |
|-----|-----------|--------------|---------------|
| 1 | Body | Ductile Iron | EN-GJS-450-10 |
| 2 | Bonnet | Ductile Iron | EN-GJS-450-10 |
| 3 | Disc | Bronze | CC491K |
| 4 | Seat Ring | Bronze | CC491K |



Features

- Robust metal-seated design for high durability
- Flanged connection for secure and easy installation
- Complies with BS 5153 and BS EN 1092-2 flange standards
- Internally and externally coated with RAL 5015 FBE for corrosion resistance
- Suitable for medium pressures (PN16) and a wide temperature range

Applications

- Water distribution networks
- Oil and gas pipelines
- Pumping stations
- Industrial and utility systems
- HVAC and fire protection systems

Technical Specifications

- Parameter Specification
- Type Flanged Metal Seated Swing Check Valve
- Size Range DN50 – DN300
- Pressure Rating PN16
- Temperature Range –10°C to 120°C
- Medium Water, Oil, Gas
- Design Standard BS 5153
- Flange Standard BS EN 1092-2
- Coating Blue RAL 5015 FBE Coating (Internal & External)

Size Range:

2" to 12" (DN50 to DN300)



BLAZE

Flanged Metal Seated Swing Check Valve

Model No. BT 1410

Dimensions

| DN | mm | 50 | 65 | 80 | 100 | 125 | 150 | 200 | 250 | 300 |
|------|----|-----|-------|-----|-----|-----|-----|-----|-----|-------|
| inch | | 2 | 2-1/2 | 3 | 4 | 5 | 6 | 8 | 10 | 12 |
| L | | 203 | 216 | 241 | 292 | 330 | 356 | 495 | 622 | 698.5 |

Note: All dimensions are for informational purposes only. Final details should be verified with the approved technical drawings.

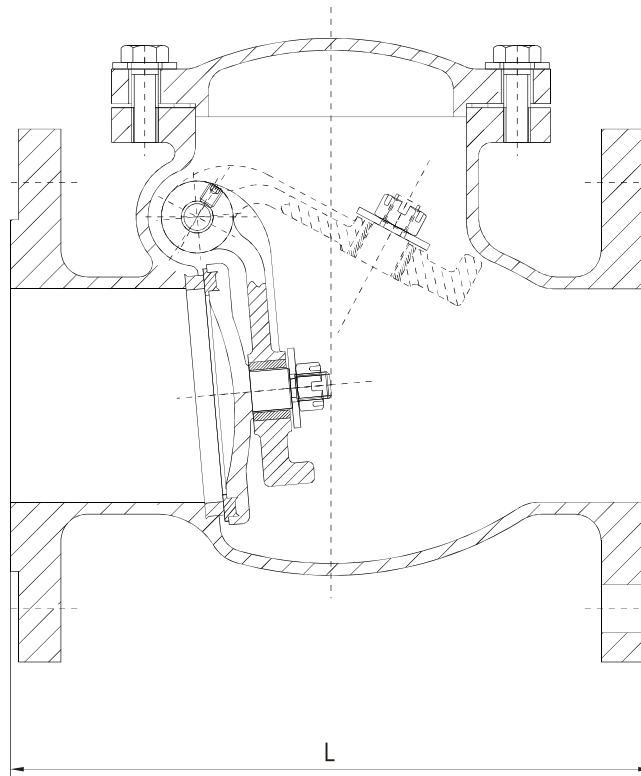

Disclaimer: Images shown are for illustration purposes only. Actual products may vary in appearance and specification. Specifications are subject to change without notice.

BLAZETECH SYSTEMS LTD. Watford, United Kingdom
Email : contact@blaze-tech.co.uk , Web: www.blaze-tech.co.uk