



## Product Overview

The BLAZE™ BT 1412 Double Door Wafer Check Valve is specifically engineered for high-pressure systems requiring reliable backflow prevention. Designed and tested to the BS EN 12334 standard, this valve is rated for working pressures up to PN 25 (25 bar), making it ideal for demanding HVAC, plumbing, and industrial applications.

Featuring a compact wafer-style body compatible with BS EN 1092-2 PN 25 flanges, the valve installs easily between flanges and offers low pressure drop. Its dual spring-loaded discs ensure rapid, quiet closing to minimize water hammer, even under high-pressure conditions.

With WRAS approval for sizes 2" to 12", the BT 1412 is suitable for potable water systems as well as heavy-duty industrial use. Durable construction with a ductile iron body and discs, WRAS-approved EPDM seat, and stainless steel springs coated in RAL 5015 epoxy blue ensures long service life and corrosion resistance.

## Material List

No.	Part Name	Material	Specification
1	SCREW	STAINLESS STEEL	BS970 304S15
2	SEALING RING	WRAS EPDM	BS EN 681-1
3	SHAFT	STAINLESS STEEL	BS970 410S11
4	BODY	DUCTILE IRON	EN-GJS-400
5	DISC	DUCTILE IRON	EN-GJS-400
6	SPRING	STAINLESS STEEL	BS970 304S15
7	GASKET	PTFE	BS EN ISO 13000
8	GASKET	PTFE	BS EN ISO 13000
9	SEAT	WRAS EPDM	BS EN 681-1
10	LIFTING RING <sup>(above 8" size)</sup>	CARBON STEEL	BS EN ISO 898-1, 8.8



## Features

- Rated for high-pressure systems up to PN 25 (25 bar)
- WRAS Approved (2" to 12") – potable water compatible
- Design per BS EN 12334
- Flange connection BS EN 1092-2 PN 25
- Operating temperature range: -20°C to +120°C
- Epoxy-coated ductile iron body (RAL 5015 Blue)
- Dual spring-assisted discs for fast, silent closure under high pressure
- Suitable for horizontal and vertical installation

## Applications

- High-pressure HVAC chilled and hot water systems
- Industrial plumbing and process water lines
- Commercial and municipal potable water systems
- Pump discharge lines requiring reliable backflow prevention



**BLAZE**

# Double Door Wafer Check Valve -PN 25

Model No. BT 1412



## Dimensions

DN	L	ØD1	A	B	ØD
50	43	65	12	16	103
65	46	80	21.5	17	123
80	64	94	22.5	25	142
100	64	117	32	24	167
125	70	145	43.5	28	192
150	76	170	51	32	218
200	89	224	70.5	41	279
250	114	264	90	40	334
300	114	310	108	44	399

**Note:** All dimensions are for informational purposes only. Final details should be verified with the approved technical drawings.

Dimensional details for valves above 12" size are available upon request.

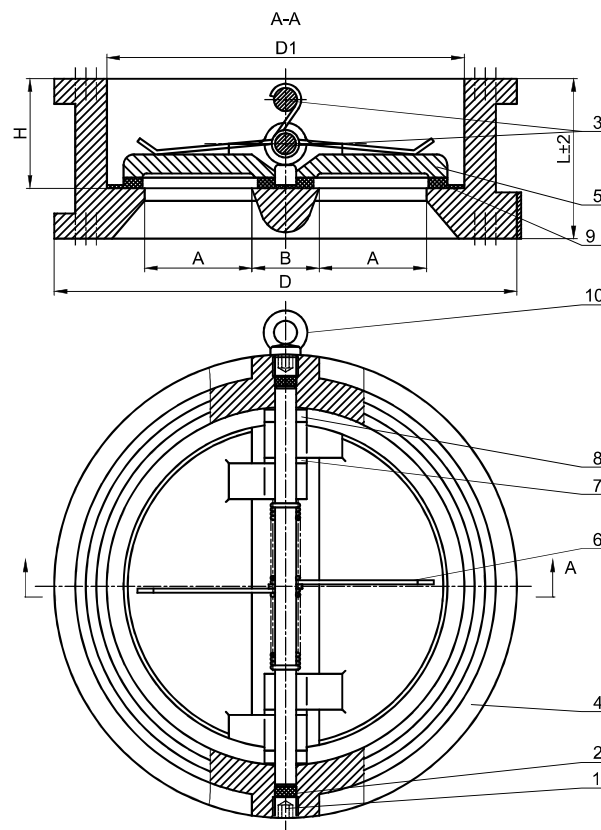

Disclaimer: Images shown are for illustration purposes only. Actual products may vary in appearance and specification. Specifications are subject to change without notice.