



BLAZE

Fixed Orifice Double Regulating Valve

Model No. BT 1420

Product Overview

The BLAZE Fixed Orifice Double Regulating Valve (FODRV) is a precision-engineered solution for balancing flow in potable water, HVAC, and mechanical systems. Designed for reliable performance, the valve features an integral orifice plate that forms a fixed orifice flow measurement unit, allowing accurate commissioning, regulation, and isolation of flow circuits. Manufactured with a ductile iron body and coated with Fusion Bonded Epoxy (RAL 5015 Blue), it offers excellent protection against corrosion and ensures safe use in potable water systems. A lockable handwheel with position indicator supports repeatable settings, while built-in test points allow direct differential pressure readings for flow verification.



Material List

No.	Part Name	Material	Specification
1	Body	Ductile Iron	EN-JS 1040
2	Disc	Ductile Iron+EPDM	EN-JS 1050+EPDM
3	Stem	Stainless Steel	BS 970 410S21
4	Stem Nut	Brass	EN 12165 CW617N
5	5 Stem Lock Bushing	Brass	EN 12165 CW617N
6	Cover	Ductile Iron	EN-JS 1040
7	Packing Gland1	Brass	EN 12165 CW617N
8	Handwheel	ABS	
	Orifice Insert	Brass(DN65-300)	EN 12165 CW 617N
		Stainless Steel(DN350-600)	BS970 304S15
	Test Valve	Brass	EN 12165 CW602N



Features

- Integral orifice plate forms a fixed flow measurement unit with regulation and isolation capabilities
- Double regulating design for precise manual adjustment
- Lockable handwheel with position indicator for consistent balancing
- Built-in test points for accurate differential pressure measurement
- FBE coating (RAL 5015) for internal and external corrosion protection
- Suitable for both supply and return installations
- PN16 flanged ends, compliant with EN 1092-2

Technical Specification

- Working Pressure: PN16
- End Connection: PN16 Flanged
- Body Material: Ductile Iron (DI)
- Coating: Fusion Bonded Epoxy (RAL 5015 Blue)
- Test Points: Included

Applications

- Potable water distribution and balancing
- HVAC chilled and hot water circuits
- Mechanical service systems
- Pump circuit and equipment flow control
- Industrial process water regulation

Size Range:

2½" to 12" (DN65 to DN300) - WRAS Approved
14" to 24" (DN350 to DN600) - Standard Design

Disclaimer: Images shown are for illustration purposes only. Actual products may vary in appearance and specification. Specifications are subject to change without notice.

**BLAZE**

Fixed Orifice Double Regulating Valve

Model No. BT 1420

Dimensions

DN	mm inch	65 2-1/2"	80 3"	100 4"	125 5"	150 6"	200 8"	250 10"	300 12"
H		228	235	239	298	311	507	570	686
L		290	310	350	400	480	600	730	850
Ø		150	150	150	150	150	280	420	420

Note: All dimensions are for informational purposes only. Final details should be verified with the approved technical drawings.

Dimensional details for valves above 12" size are available upon request.

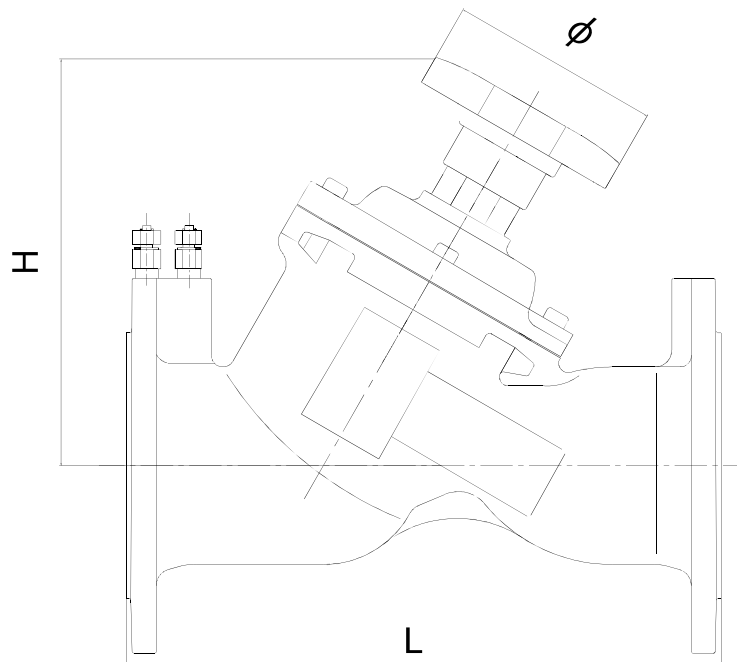

-20

Disclaimer: Images shown are for illustration purposes only. Actual products may vary in appearance and specification. Specifications are subject to change without notice.

BLAZETECH SYSTEMS LTD. Watford, United Kingdom
Email : contact@blaze-tech.co.uk , Web: www.blaze-tech.co.uk