



Product Overview

The BLAZE BT 1301 is a compact, high-performance bronze ball valve designed for reliable shut-off in water, oil, and steam systems. With a PN 25 pressure rating and WRAS approval, it is ideal for residential, commercial, and industrial use.

Material List

No.	Part Name	Material	Specification
1	Seat Retainer	Bronze	EN 1982 CC491K
2	Gasket	PTFE	-
3	Seat	PTFE	-
4	Ball	Brass	EN 12165 CW614N
5	Body	Bronze	EN 1982 CC491K
6	Stem	Brass	EN 12165 CW614N
7	Stem Gasket	PTFE	-
8	Packing	PTFE	-
9	Gland Nut	Brass	EN 12165 CW614N
10	Lever	Steel	Q235
11	Lever cover	PVC	-
12	Gasket	-	65Mn
13	Lever Nut	Brass	-



Features

- Bronze body for corrosion resistance
- Full bore design (if applicable)
- WRAS approved for potable water
- BSPT threaded ends (ISO 7)
- PN 25 (2.5 MPa) working pressure
- Max temperature <170°C
- Size range: ½"–2" (DN15–DN50)

Applications

- Water supply and plumbing systems
- Steam and oil pipelines
- HVAC installations
- General fluid shut-off in residential and industrial systems

Technical Specifications

- Parameter Value
- Size Range ½"–2" (DN15–DN50)
- Material Bronze
- Working Pressure PN 25 (2.5 MPa)
- Max Temperature <170°C
- Connection Type BSPT (ISO 7)
- Medium Water, Oil, Steam
- Certification WRAS Approved

Disclaimer: The image shown in this data sheet is for illustration purposes only. The actual product may vary based on manufacturing standards and specifications.



Dimensions

DN	INCH	L	L1	d	H
15	½"	95	14	14	44
20	¾"	110	19	19	51
25	1"	110	24	24	55
32	1¼"	140	31	31	65
40	1½"	140	38	38	70
50	2"	160	49	49	83

Note: All dimensions are provided for informational purposes only. Please cross-check and confirm with the official technical drawings before installation or fabrication.

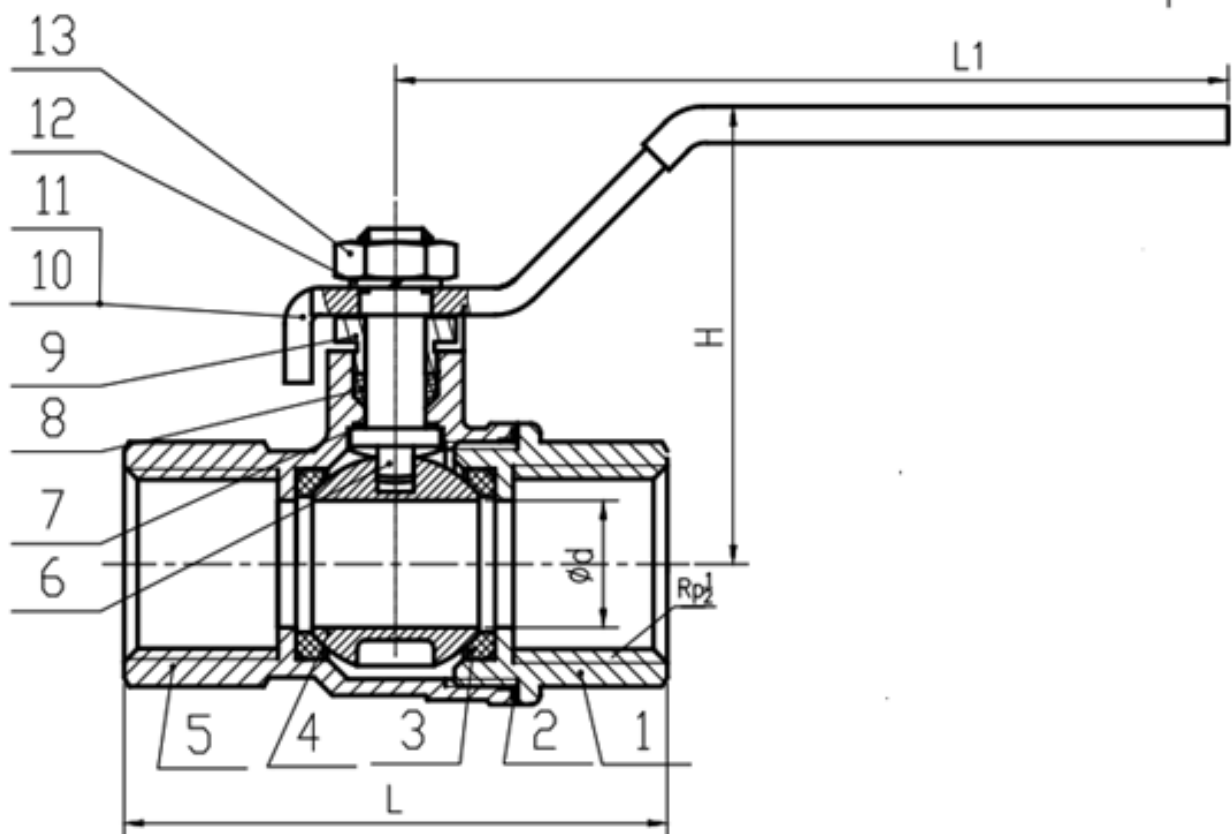

Disclaimer: The image shown in this data sheet is for illustration purposes only. The actual product may vary based on manufacturing standards and specifications.