



**BLAZE**



# Test & Drain Valve

## Model BT-5550

### Description:

The BT 5550 Model Test and Drain Valve is a multi-functional 3-way forged brass valve specifically designed for the inspection and maintenance of fire sprinkler systems (compliant with NFPA 13, 13R, and 13D).

### Key Features:

- **Three-in-One Operation:** It serves as a stop valve during normal use, but can be switched to perform flow testing or to drain the system for maintenance.
- **Integrated Monitoring:** Features built-in, tamper-resistant sight glasses for visual confirmation of flow and a test orifice to simulate the activation of a single sprinkler head.
- **Space-Saving:** Replaces the need for multiple separate components (test loops, drain valves, and sight glasses) with one compact unit.
- **Reliability:** The tamper-resistant design prevents unauthorized adjustments to the test orifice or sight glasses.
- Single-handle ball valves featuring three distinct operating positions
- Lockable OFF position for secure system shutdown



### Material Specifications :

<b>Sizes</b>	DN 25, DN32, DN40, DN 50 (1", 1 1/4", 1 1/2", 2")
<b>Maximum Working Pressure</b>	300 psi (20.7 bar)
<b>Approvals</b>	FM Approved / UL Listed
<b>End Connection</b>	Threaded, BSPT as Standard ( NPT Optional)
<b>Body</b>	High-strength Forged Brass for corrosion resistance.
<b>Ball</b>	Chrome-plated brass for smooth operation and durability.
<b>Seats/Seals</b>	PTFE (Teflon), ensuring a tight seal and low-friction turning.
<b>K factors</b>	3/8" (K2.8), 7/16" (K4.2), 1/2" (K5.6), 17/32" (K8.0)
<b>Stem</b>	304SS
<b>Sight Glass</b>	Polycarbonate
<b>Indicator Plate / Handle</b>	Steel

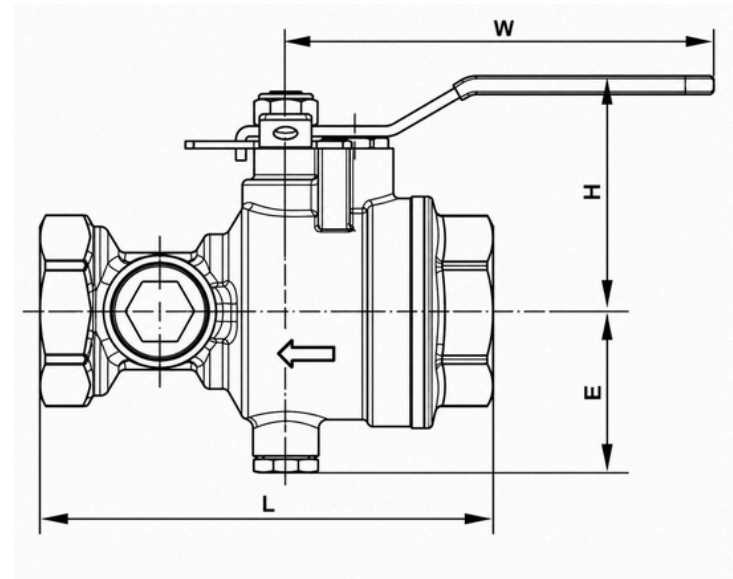

Part Number	Size		L		H		E		W		Weight	
	In.	mm	In.	mm	In.	mm	In.	mm	In.	mm	lbs	Kgs
BT-5550-025	1"	25	5.12"	130	2.68"	68	1.81"	46	4.96"	126	2.87	1.3
BT-5550-032	1-1/4"	32	5.12"	130	2.68"	68	1.81"	46	4.96"	126	3.09	1.4
BT-5550-040	1-1/2"	40	6.81"	173	3.31"	84	2.28"	58	6.14"	156	6.62	3.0
BT-5550-050	2"	50	6.81"	173	3.31"	84	2.28"	58	6.14"	156	7.06	3.2

## BLAZETECH SYSTEMS LTD.

contact@blaze-tech.co.uk

Milton Keynes, United Kingdom

www.blaze-tech.co.uk

Disclaimer: Images shown are for illustration purposes only. Actual products may vary in appearance and specification. Specifications are subject to change without notice.

PRECISION YOU CAN TRUST

01/01

Ver. A, 15032026, © Blaze 2026